



10 Bellevue Road Faulconbridge NSW

5  3  2 

S-t-r-e-t-c-h out in this colossal home and treat your family to the space they deserve. The versatile floor plan can adapt to your family's needs should they change over time.

- + Expansive split level floor plan
- + Generous servings of living space
- + The comfort of ducted air conditioning
- + Built in wardrobes | walk in robe to main
- + Timber deck to host social gatherings
- + Grassed yard for pets & children to roam

You can inspect our properties at both open homes and by appointment and of course, bring your partner and family along so you can view your next home together.

Type : House
Price : \$ 850,000
Land Size : 695 sqm
View : <https://www.aitkenre.com.au/8058720>



David Reeves
02 4735 2121

[For full version visit the website](https://www.aitkenre.com.au)

Ground floor
70.6 sq.m. approx.

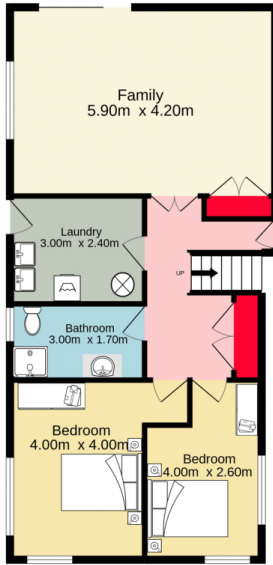

Entrance floor
116.8 sq.m. approx.

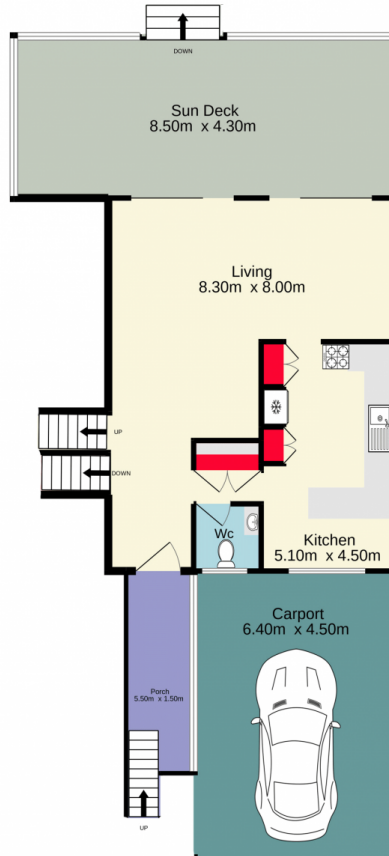

1st floor
68.8 sq.m. approx.

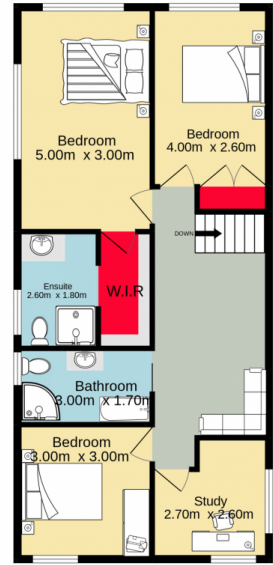

TOTAL FLOOR AREA : 256.2 sq.m. approx.

Whilst every attempt has been made to ensure the accuracy of the floorplan contained here, measurements of doors, windows, rooms and any other items are approximate and no responsibility is taken for any error, omission or mis-statement. This plan is for illustrative purposes only and should be used as such by any prospective purchaser. The services, systems and appliances shown have not been tested and no guarantee as to their operability or efficiency can be given.
Made with Metropix ©2022

