



17 Gwandalan Street Emu Plains NSW

4 2 4

Position perfect and improved over time, this family residence will suit your growing family now and into the future. Spacious living zones and a host of inclusions will ensure that this home goes straight to the top of your list.

- + Meticulously maintained
- + Comfort of split system air conditioning | ceiling fans
- + Enclosed entertaining area for social gatherings
- + Substantial child | pet friendly backyard
- + Dedicated caravan parking | slab
- + Approx 450m to two Primary Schools
- + Approx 750m to Woolworths | Aldi | specialty shops
- + Approx 500m to the banks of the Nepean River

You can inspect our properties at both open homes and by

[For full version visit the website](https://www.aitkenre.com.au)

Type : House
Price : \$ 1,150,000
Land Size : 651 sqm
View : <https://www.aitkenre.com.au/8058713>



David Reeves
02 4735 2121



Dillon Blundell
02 4732 5055

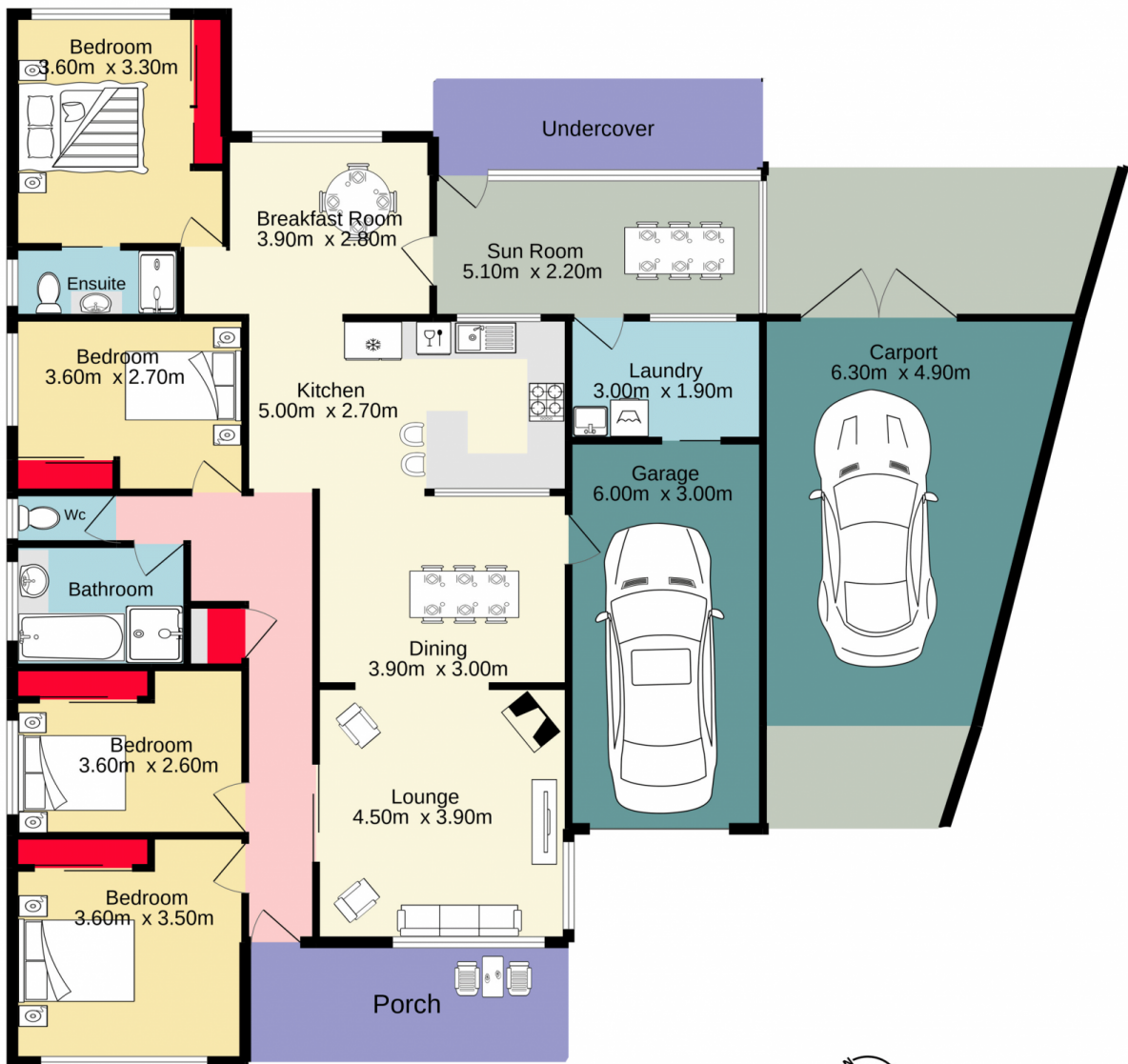

Jim Aitken
Partners



TOTAL FLOOR AREA : 191.4 sq.m. approx.

Whilst every attempt has been made to ensure the accuracy of the floorplan contained here, measurements of doors, windows, rooms and any other items are approximate and no responsibility is taken for any error, omission or mis-statement. This plan is for illustrative purposes only and should be used as such by any prospective purchaser. The services, systems and appliances shown have not been tested and no guarantee as to their operability or efficiency can be given.
Made with Metropix ©2022