



19 Currawong Crescent Leonay NSW

3  2  4 

Stretching across a split level design, this grand residence is nestled in the ever popular and tightly held suburb of Leonay. Adorned with quality inclusions, this a spectacular fusion of design and quality. There are indoor / outdoor entertaining options and a sparkling in ground pool.

- + A selection of formal and informal living spaces
- + Alfresco zones for social gatherings
- + The comfort of ducted air conditioning
- + Renovated bathroom
- + Renovated kitchen
- + Envious location | high side of the street

DISCLAIMER: Whilst we deem this information to be reliable the agent cannot guarantee its accuracy and

Type : House
Land Size : 665 sqm
View : <https://www.aitkenre.com.au/8058540>



David Reeves
02 4735 2121



Troy Meredith
0421 032 267

[For full version visit the website](https://www.aitkenre.com.au)

Ground floor
113.9 sq.m. approx.



Entrance floor
64.0 sq.m. approx.



1st floor
56.3 sq.m. approx.

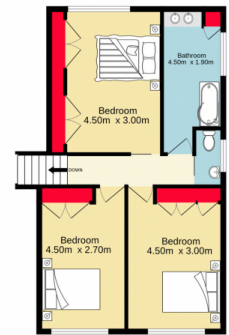

Jim Aitken
Partners



TOTAL FLOOR AREA : 234.2 sq.m. approx.

Whilst every attempt has been made to ensure the accuracy of the floorplan contained here, measurements of doors, windows, rooms and any other items are approximate and no responsibility is taken for any error, omission or mis-statement. This plan is for illustrative purposes only and should be used as such by any prospective purchaser. The services, systems and appliances shown have not been tested and no guarantee as to their operability or efficiency can be given.
Made with Metropix ©2023