



24 Womra Crescent Glenmore Park NSW

4  2  4 

This family home is positioned on a wonderful parcel of land that can be accessed via the drive through garage or by utilising the potential for side access. Internally there are separate living zones and comfortable proportions throughout.

- + Split System Air Conditioning
- + Formal and informal living zones
- + Large pet | family friendly yard
- + Covered entertaining area
- + Granny Flat Potential (subject to council approval)

Restrictions have been reimposed by the State Government that require inspections to be by appointment only. Properties may now only be shown to ONE person at

Type : House
Price : \$ 917,000
Land Size : 744 sqm
View : <https://www.aitkenre.com.au/8058528>



David Reeves
02 4735 2121

[For full version visit the website](https://www.aitkenre.com.au)

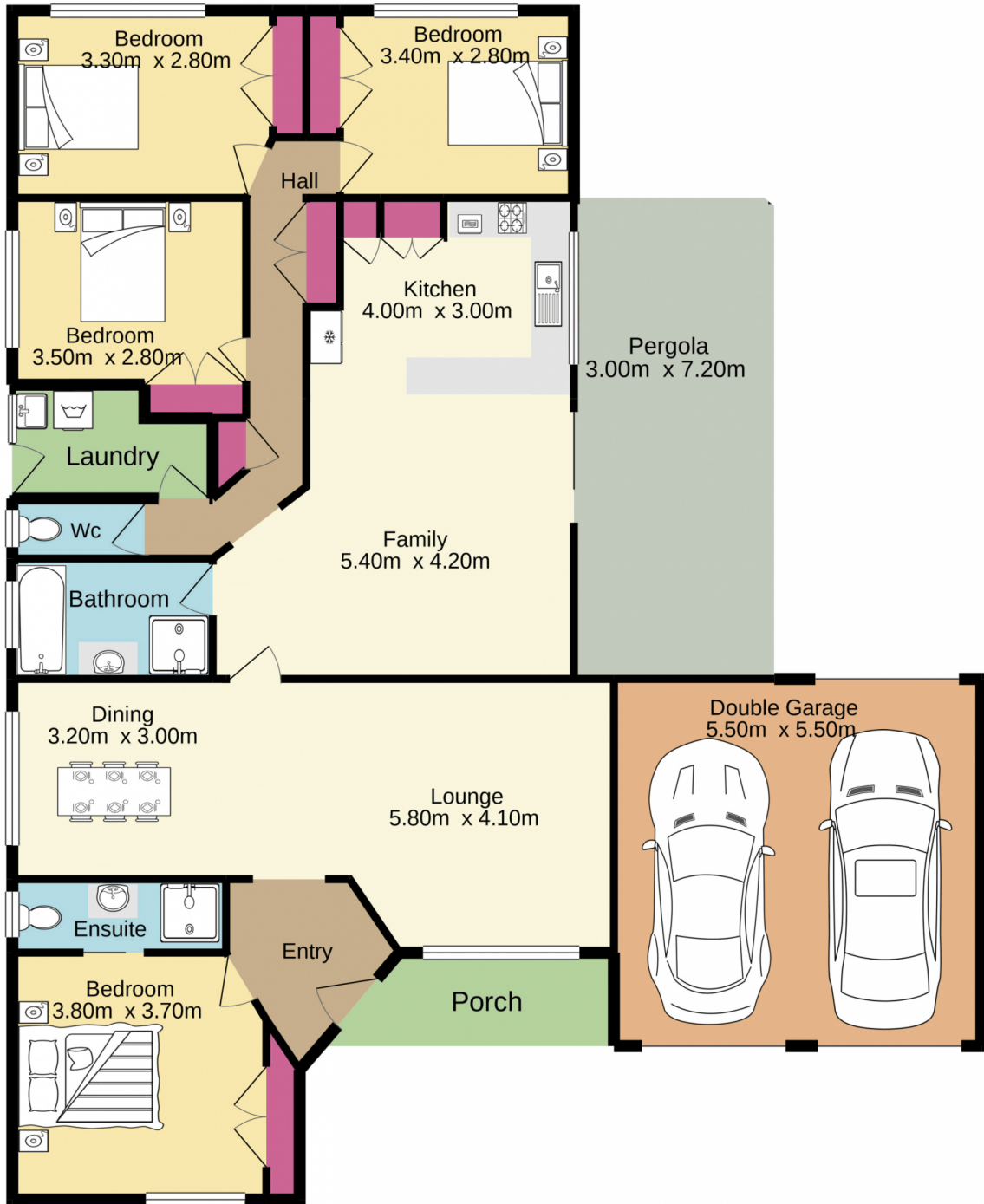

Jim Aitken
Partners

TOTAL FLOOR AREA : 185.4 sq.m. approx.

Whilst every attempt has been made to ensure the accuracy of the floorplan contained here, measurements of doors, windows, rooms and any other items are approximate and no responsibility is taken for any error, omission or mis-statement. This plan is for illustrative purposes only and should be used as such by any prospective purchaser. The services, systems and appliances shown have not been tested and no guarantee as to their operability or efficiency can be given.
Made with Metropix ©2021

