



**10 Harpur Close Glenmore Park NSW**

5 🏠 2 🚗 4 🚗

Nestled in the opening stages of Glenmore Park, this expansive residence will cater for the family and extended family. Enjoying generous servings of living space you will be able to offer each of your family members the space they deserve.

- + The comfort of ducted air conditioning throughout
- + Recently renovated cooking quarters
- + Downstairs bedroom | Office
- + Separate rumpus | media room
- + 12x Solar panels
- + Alfresco zone with outdoor spa
- + In ground pool | Solar heating

**Type** : House  
**Price** : \$ 950,000  
**Land Size** : 715 sqm  
**View** : <https://www.aitkenre.com.au/8058440>

Recently the NSW State Government announced the ban

[For full version visit the website](#)



**David Reeves**  
**02 4735 2121**

Ground floor  
181.1 sq.m. approx.

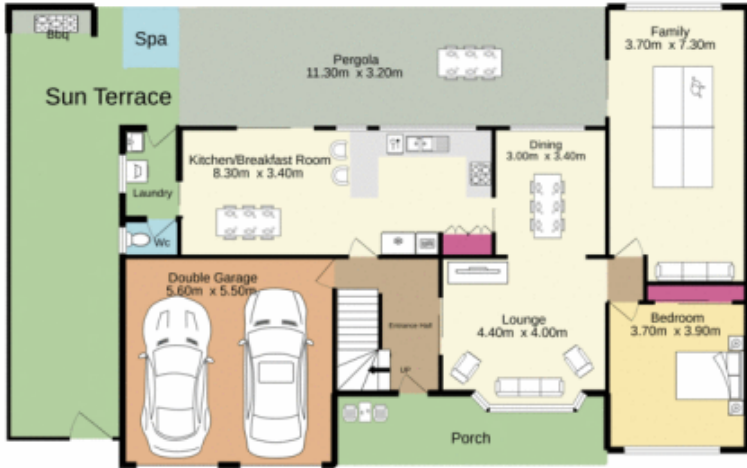

1st floor  
71.0 sq.m. approx.

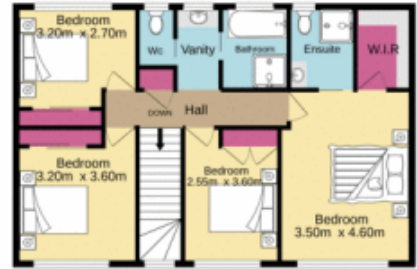

TOTAL FLOOR AREA: 252.1 sq.m. approx.

Whilst every attempt has been made to ensure the accuracy of the floorplan contained here, measurements of doors, windows, rooms and any other items are approximate and no responsibility is taken for any error, omission or mis-statement. This plan is for illustrative purposes only and should be used as such by any prospective purchaser. The services, systems and appliances shown have not been tested and no guarantee as to their operability or efficiency can be given.  
Made with Metropix ©2020

