



5 Burra Close Glenmore Park NSW

5  2  4 

Meticulously maintained and enhanced over time, you will certainly become the family favourite if you can secure this fantastic opportunity. Social gatherings can be hosted in a selection of internal zones, under the covered entertaining space or enjoyed in the surrounds of the grassed yard. Don't stare from the street, call now for a private viewing or watch for open home times.

- + Formal/informal living
- + Modern flooring
- + Renovated bathrooms
- + Stunning cooking quarters
- + Grassed yard + est gardens
- + Outdoor entertaining zones
- + Ducted A/C + ceiling fans

[For full version visit the website](https://www.aitkenre.com.au/8058362)

Type : House
Price : \$ 980,000
Building Size : 192 sqm
Land Size : 768 sqm
View : <https://www.aitkenre.com.au/8058362>



David Reeves
02 4735 2121

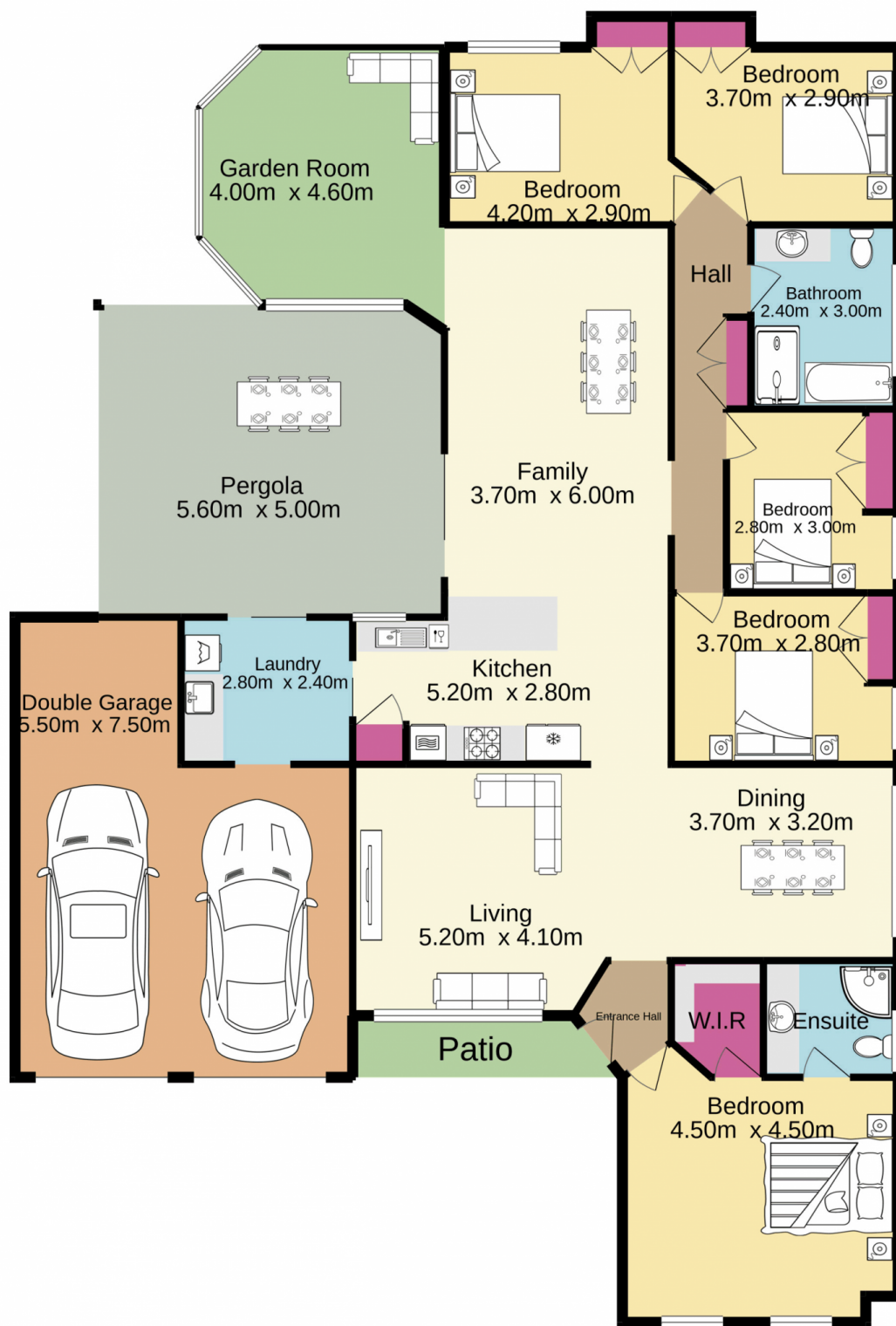

Jim Aitken
+ Partners

TOTAL FLOOR AREA : 220.3 sq.m. approx.

Whilst every attempt has been made to ensure the accuracy of the floorplan contained here, measurements of doors, windows, rooms and any other items are approximate and no responsibility is taken for any error, omission or mis-statement. This plan is for illustrative purposes only and should be used as such by any prospective purchaser. The services, systems and appliances shown have not been tested and no guarantee as to their operability or efficiency can be given.
Made with Metropix ©2021