



12 Gwandalan Street Emu Plains NSW

4  2  4 

Experience the convenience in this wonderful residence that combines a modern finish with a fresh and inviting decor. The polished floor boards are a visual delight and lead to spacious bedrooms and a selection of versatile living spaces.

- + New kitchen | 40mm stone
- + S/S Air Conditioning x2
- + Built in wardrobes
- + Over sized master suite
- + Optional parents retreat
- + Side access
- + Position perfect

450m to Nepean River | 160m to Hunter Fields | 600m to

[For full version visit the website](https://www.aitkenre.com.au/8058230)

Type : House
Land Size : 556 sqm
View : <https://www.aitkenre.com.au/8058230>



David Reeves
02 4735 2121



Andrew Lia
02 4735 2121

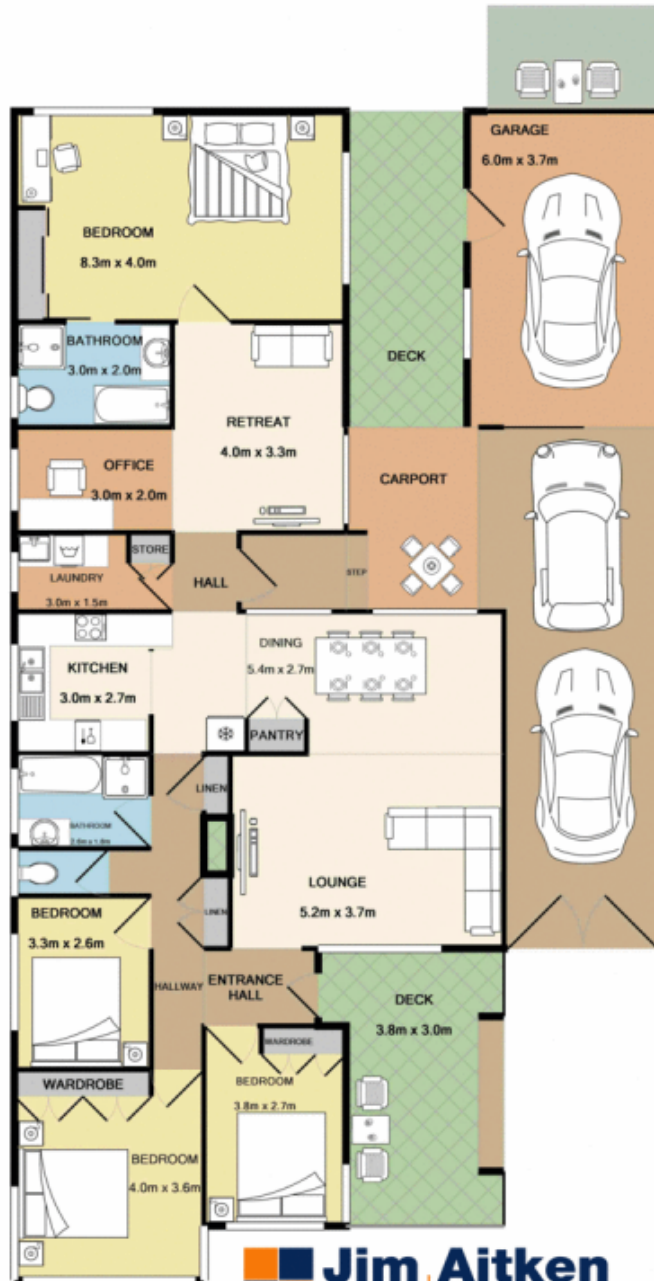

Whilst every attempt has been made to ensure the accuracy of the floor plan contained here, measurements of doors, windows, rooms and any other items are approximate and no responsibility is taken for any error, omission, or mis-statement. This plan is for illustrative purposes only and should be used as such by any prospective purchaser. The services, systems and appliances shown have not been tested and no guarantee as to their operability or efficiency can be given.
Made with Metropix (C)2019