



### 11 Hollier Street Cambridge Park NSW

3  1  8 

Ready for a new family to occupy, this home is larger than most and offers all the must haves for the growing family. The huge living space leads out to the covered area, the kitchen has been updated and increased in size, split system air conditioning controls comfort. Side access is a welcome feature as is the double carport and private grassed yard.

- \* Spacious kitchen
- \* Huge Lounge room
- \* Split system A/C
- \* Built in robes
- \* Side access
- \* Carport/entertaining area
- \* Updated bathroom

**Type** : House  
**Building Size** : 135 sqm  
**Land Size** : 613 sqm  
**View** : <https://www.aitkenre.com.au/8057757>



**David Reeves**  
02 4735 2121

[For full version visit the website](https://www.aitkenre.com.au)

<https://www.aitkenre.com.au>

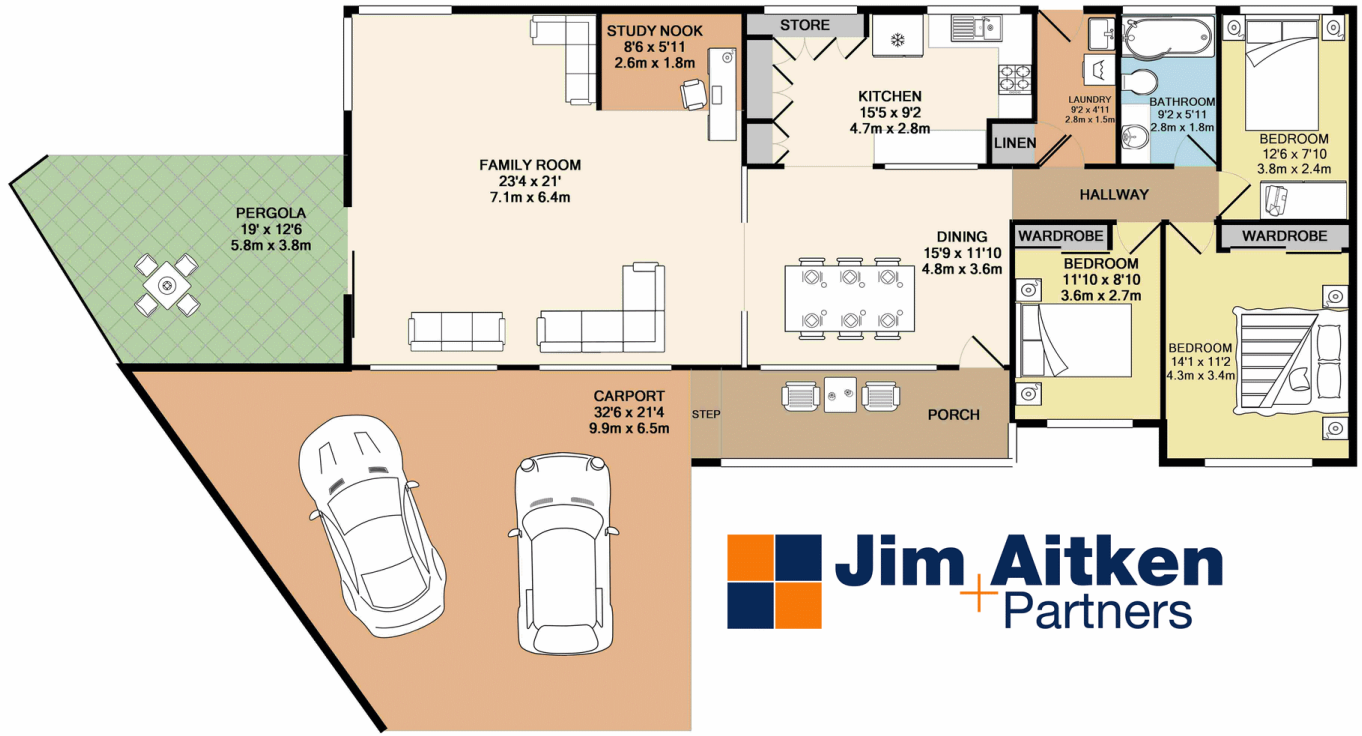

Whilst every attempt has been made to ensure the accuracy of the floor plan contained here, measurements of doors, windows, rooms and any other items are approximate and no responsibility is taken for any error, omission, or mis-statement. This plan is for illustrative purposes only and should be used as such by any prospective purchaser. The services, systems and appliances shown have not been tested and no guarantee as to their operability or efficiency can be given.  
 Made with Metropix ©2017